

一. R 系列结构图
R series structural drawing

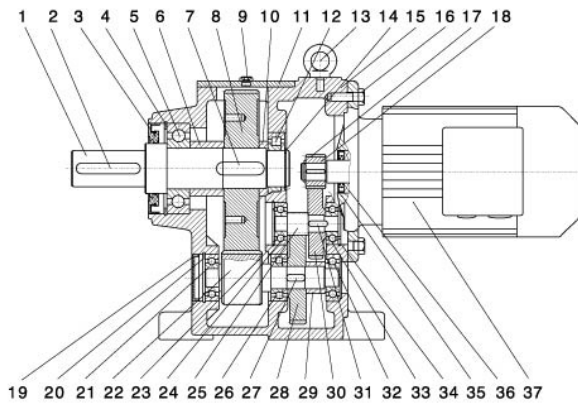

- | | | | |
|-----------|-------------|--------------|-------------|
| 1. 输出轴 | 10. 轴套 II | 19. 封盖 | 28. 齿轮 II |
| 2. 平键 I | 11. 盖 | 20. 孔用挡圈 II | 29. 轴套 III |
| 3. 输出轴油封 | 12. 轴承 II | 21. 轴承 III | 30. 齿轮 I |
| 4. 孔用挡圈 I | 13. 吊环 | 22. 齿轮轴 III | 31. 平键 IV |
| 5. 轴承 I | 14. 轴用挡圈 I | 23. 孔用挡圈 III | 32. 轴承 VI |
| 6. 轴套 I | 15. 箱体 | 24. 轴承 IV | 33. 轴承 VII |
| 7. 平键 II | 16. 螺栓 | 25. 齿轮轴 II | 34. 孔用挡圈 IV |
| 8. 齿轮 III | 17. 轴用挡圈 II | 26. 轴承 V | 35. 电机油封 |
| 9. 通气帽 | 18. 输入齿轮 | 27. 平键 III | 36. 电机轴承 |
| | | | 37. 电机 |
-
- | | | |
|----------------------|--------------------|----------------------|
| 1. Output shaft | 13. Hoisting ring | 25. Gear shaft II |
| 2. Parallel key | 14. Circlip II | 26. Bearing V |
| 3. Output shaft seal | 15. Housing | 27. Parallel key III |
| 4. Circlip I | 16. Bolts | 28. Gear II |
| 5. Bearing I | 17. Circlip II | 29. Bush III |
| 6. Bush I | 18. Input gear | 30. Gear I |
| 7. Parallel key II | 19. Cover | 31. Parallel key IV |
| 8. Gear III | 20. Circlip II | 32. Bearing VI |
| 9. Breather valve | 21. Bearing III | 33. Bearing VIII |
| 10. Bush II | 22. Gear shaft III | 34. Circlip IV |
| 11. Cover | 23. Circlip III | 35. Motor seal |
| 12. Bearing II | 24. Bearing IV | 36. Motor bearing |
| | | 37. Motor |

二. F 系列结构图
F series structural drawing

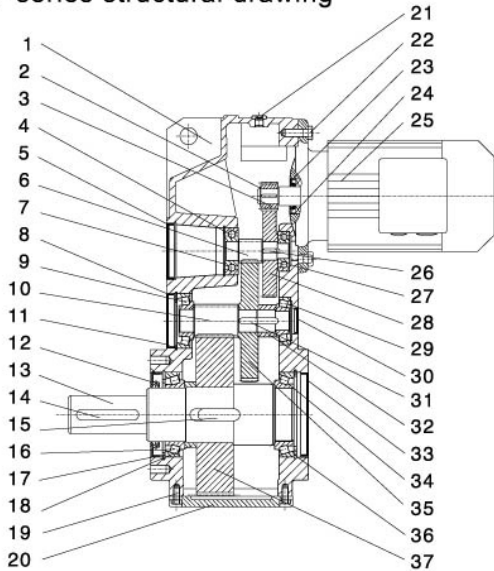

- | | | | |
|-----------|--------------|------------|-------------|
| 1. 箱体 | 10. 齿轮轴 III | 19. 螺栓 | 28. 齿轮 I |
| 2. 轴用挡圈 I | 11. 孔用挡圈 II | 20. 盖 | 29. 轴承 V |
| 3. 输入齿轮 | 12. 输出轴油封 | 21. 通气帽 | 30. 封盖 III |
| 4. 孔用挡圈 I | 13. 输出轴 | 22. 螺栓 | 31. 平键 IV |
| 5. 封盖 I | 14. 平键 I | 23. 电机油封 | 32. 轴套 II |
| 6. 齿轮轴 II | 15. 平键 II | 24. 电机轴承 | 33. 封盖 IV |
| 7. 轴承 I | 16. 轴承 III | 25. 电机 | 34. 轴承 VI |
| 8. 封盖 II | 17. 孔用挡圈 III | 26. 平键 III | 35. 齿轮 II |
| 9. 轴承 II | 18. 轴套 III | 27. 轴承 IV | 36. 孔用挡圈 IV |
| | | | 37. 齿轮 III |
-
- | | | |
|-----------------------|---------------------|----------------------|
| 1. Housing | 13. Output shaft | 25. Motor |
| 2. Circlip I | 14. Parallel key I | 26. Parallel key III |
| 3. Output gear | 15. Parallel key II | 27. Bearing IV |
| 4. Circlip I | 16. Bearing III | 28. Gear I |
| 5. Cover | 17. Circlip III | 29. Bearing V |
| 6. Gear shaft II | 18. Bush III | 30. Cover III |
| 7. Bearing I | 19. Bolts | 31. Parallel key IV |
| 8. Cover II | 20. Cover | 32. Bush II |
| 9. Bearing II | 21. Breather valve | 33. Cover IV |
| 10. Gear shaft III | 22. Bolts | 34. Bearing VI |
| 11. Circlip II | 23. Motor seal | 35. Gear II |
| 12. Output shaft seal | 24. Motor bearing | 36. Circlip IV |
| | | 37. Gear III |

三. T 系列结构图
T series structural drawing

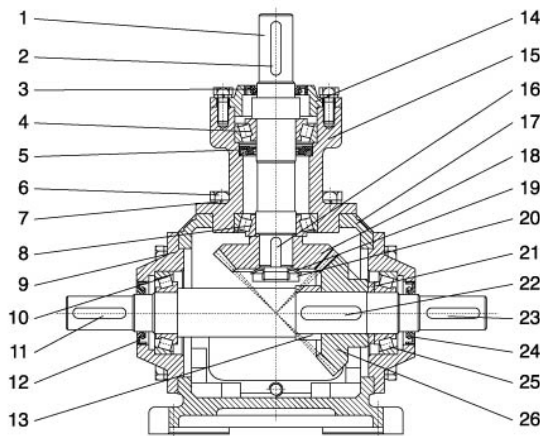

- | | | |
|----------|-------------|--------------|
| 1. 输入轴 | 10. 轴承 III | 19. 止动垫圈 |
| 2. 平键 I | 11. 平键 II | 20. 圆螺母 |
| 3. 输入轴油封 | 12. 输出轴油封 I | 21. 调整垫 I |
| 4. 轴承 I | 13. 调整垫 II | 22. 平键 IV |
| 5. 输入轴油封 | 14. 输入法兰盖 | 23. 平键 V |
| 6. 螺栓 | 15. 输入法兰 | 24. 输出轴油封 II |
| 7. 弹簧垫圈 | 16. 平键 III | 25. 轴承 IV |
| 8. 轴承 II | 17. 箱体 | 26. 输出弧齿锥齿轮 |
| 9. 输出法兰 | 18. 输入弧齿锥齿轮 | |
-
- | | | |
|---------------------|-------------------------------|--------------------------------|
| 1. Input shaft | 10. Bearing III | 19. Washer |
| 2. Parallel key I | 11. Parallel key II | 20. Round screw nut |
| 3. Input shaft seal | 12. Output shaft seal I | 21. Ring I |
| 4. Bearing I | 13. Ring II | 22. Parallel key IV |
| 5. Input shaft seal | 14. Input flange cover | 23. Parallel key V |
| 6. Bolts | 15. Input flange | 24. Output shaft seal II |
| 7. Washer | 16. Parallel key III | 25. Bearing IV |
| 8. Bearing II | 17. Housing | 26. Output helical -bevel gear |
| 9. Output flange | 18. Input helical -bevel gear | |

四. K系列结构图

K series structural drawing

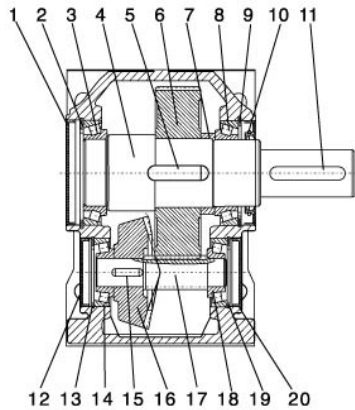

- 1.封盖 I 8.轴承 II 15.平键 III
- 2.孔用挡圈 I 9.孔用挡圈 II 16.弧齿锥齿轮
- 3.轴承 I 10.输出轴油封 17.齿轮轴 III
- 4.输出轴 11.平键 II 18.轴承 IV
- 5.平键 I 12.封盖 II 19.孔用挡圈 IV
- 6.齿轮 III 13.孔用挡圈 III 20.封盖 III
- 7.轴套 III 14.轴承 III 21.通气帽

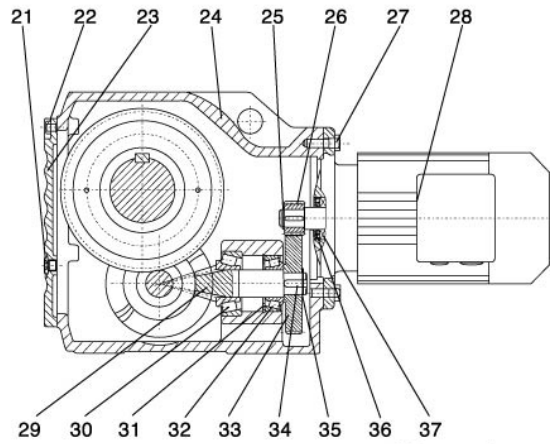

- 22.螺栓 I 29.弧齿锥齿轮轴 1. Cover I
- 23.端盖 30.轴承 V 2. Circlip I
- 24.箱体 31.孔用挡圈 V 3. Bearing I
- 25.轴用挡圈 I 32.轴承 VI 4. Output shaft
- 26.输入齿轮 33.齿轮 I 5. Parallel key I
- 27.螺栓 II 34.平键 IV 6. Gear III
- 28.电机 35.轴用挡圈 II 7. Bush III
- 29.弧齿锥齿轮轴 36.电机油封 8. Bearing II
- 30.轴承 V 37.电机轴承
- 31.孔用挡圈 V 9. Circlip II
- 32.轴承 VI 10. Output shaft seal
- 33.齿轮 I 11. Parallel key II
- 34.平键 IV 12. Cover II
- 35.轴用挡圈 II 13. Circlip III
- 36.电机油封 14. Bearing III
- 37.电机轴承 15. Parallel key III

五. S系列结构图

S series structural drawing

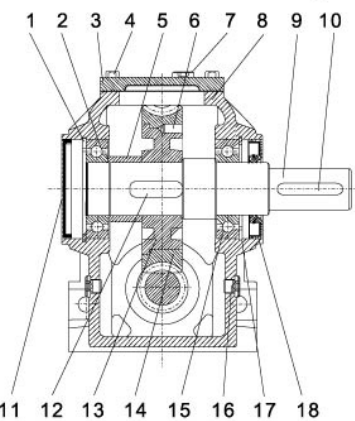

- 1.孔用挡圈 I 7.通气帽 13.蜗轮芯
- 2.轴承 I 8.箱体 14.蜗轮轮缘
- 3.盖 9.输出轴 15.轴承 II
- 4.螺栓 II 10.平键 I 16.油镜
- 5.轴套 III 11.封盖 I 17.孔用挡圈 II
- 6.螺钉 12.平键 II 18.输出轴油封

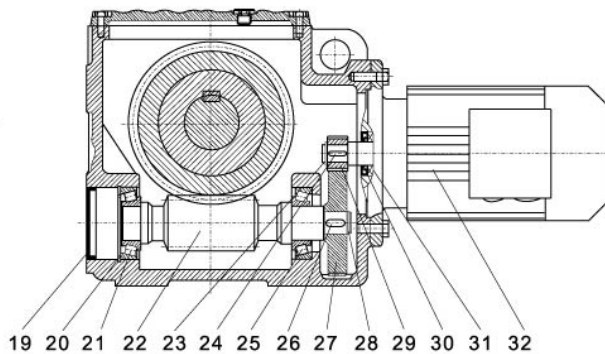

- 19.封盖 II 20.孔用挡圈 III 26.平键 IV
- 21.轴承 III 22.蜗杆 27.齿轮 I
- 22.蜗杆 23.轴用挡圈 I 28.轴用挡圈 II
- 23.轴用挡圈 I 24.平键 III 29.输入齿轮
- 24.平键 III 25.轴承 IV 30.电机油封
- 25.轴承 IV 26.平键 IV 31.电机轴承
- 26.平键 IV 27.齿轮 I 32.电机
- 27.齿轮 I 28.轴用挡圈 II
- 28.轴用挡圈 II 29.输入齿轮
- 29.输入齿轮 30.电机油封
- 30.电机油封 31.电机轴承
- 31.电机轴承 32.电机
- 1. Circlip I
- 2. Bearing I
- 3. Cover
- 4. Bolts II
- 5. Bush III
- 6. Screws
- 7. Breather valve
- 8. Housing
- 9. Output shaft
- 10. Parallel key I
- 11. Cover I
- 12. Parallel key II
- 13. Worm wheel core
- 14. Worm wheel edge
- 15. Bearing II
- 16. Oil sight glass
- 17. Circlip II
- 18. Output shaft seal
- 19. Cover II
- 20. Circlip III
- 21. Bearing III
- 22. Worm
- 23. Circlip I
- 24. Parallel key III
- 25. Bearing IV
- 26. Parallel key IV
- 27. Gear I
- 28. Circlip II
- 29. Input gear
- 30. Motor seal
- 31. Motor bearing
- 32. Motor

六. H、B系列结构图

H、B series structural drawing

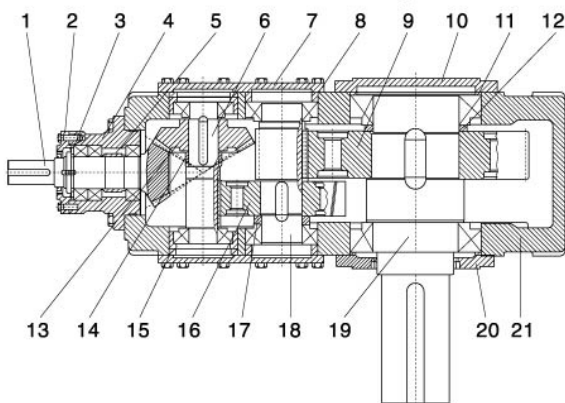

- 1.弧齿锥齿轮轴 8.调整环 III 15.调整环 II
- 2.通盖 I 9.齿轮 III 16.齿轮 II
- 3.调整环 I 10.止盖 II 17.定距环 III
- 4.轴承座 11.调整环 IV 18.齿轮轴 II
- 5.定距环 I 12.定距环 IV 19.输出轴
- 6.齿轮轴 I 13.弧齿锥齿轮 20.通盖 II
- 7.止盖 I 14.定距环 II 21.机体
- 1. Helical-bevel gear shaft
- 2. Cover I
- 3. Ring I
- 4. Bearing seat
- 5. Ring I
- 6. Gear shaft I
- 7. Cover I
- 8. Ring III
- 9. Gear III
- 10. Cover II
- 11. Ring IV
- 12. Ring IV
- 13. Helical-bevel gear
- 14. Ring II
- 15. Ring II
- 16. Gear II
- 17. Ring III
- 18. Gear shaft II
- 19. Output shaft
- 20. Cover II
- 21. Housing