

外形安装尺寸  
Mounting Dimension Sheets-overview

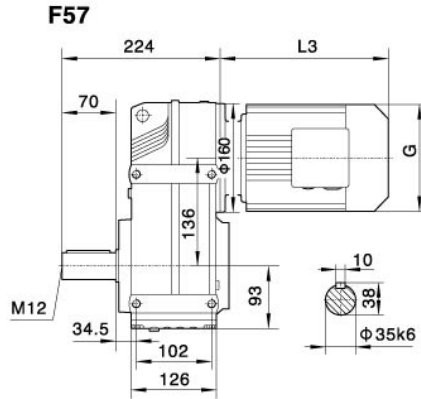

FA57/FAF57/FAZ57空心轴  
/Hollow shaft

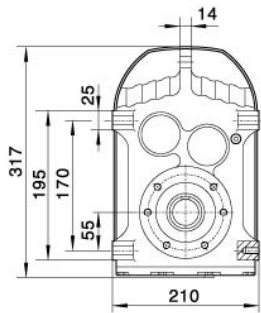
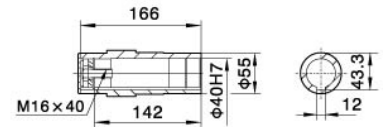

F..T57

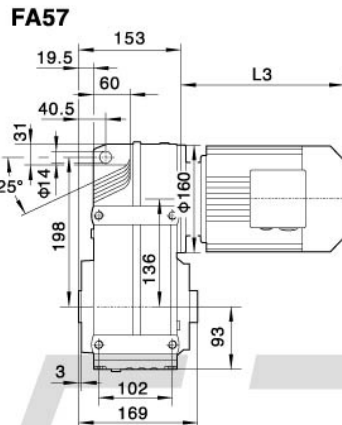
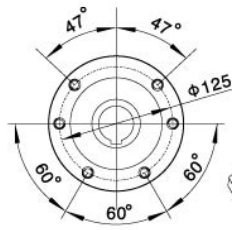
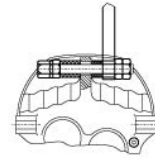

FAZ57

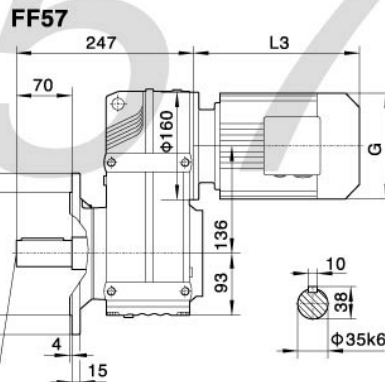
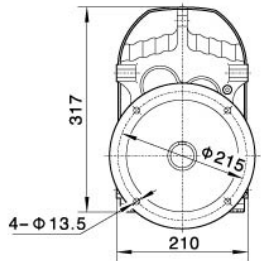
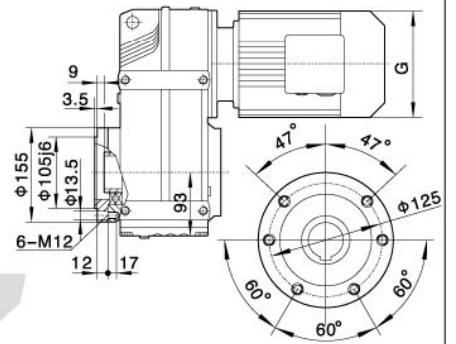

FAF57

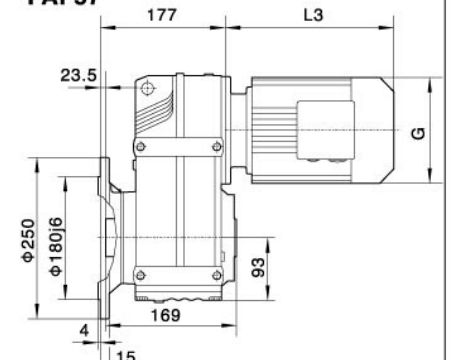

电机需方配或配特殊电机时需加联接法兰

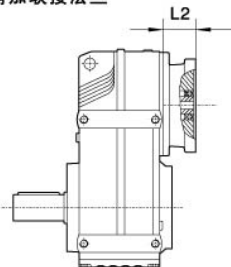

F..57R37

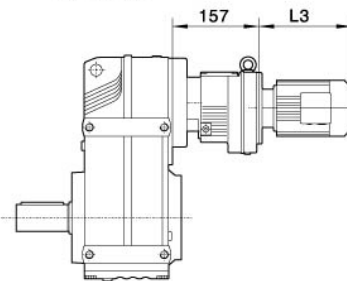

F..S57

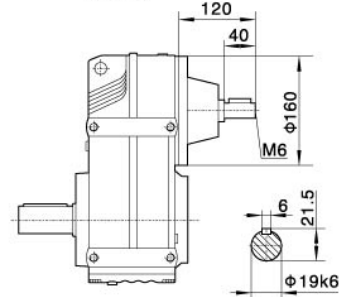

注：其余尺寸见  
相对应结构形式  
Note:For other  
values please  
refer to the o-  
pposited stru-  
cture.

When equipping the user's motor or the special one, the flange is required to be connected.

Y2电机座号 Motor size	63	71		80		90S	90L	100		112M	132S
功率/4P Power/(kW)	0.18	0.25	0.37	0.55	0.75	1.1	1.5	2.2	3	4	5.5
L3	223	245		278		304	328	350		380	425
G	130	145		175		195	195	215		240	275
L2	81	81		81		81	81	93		93	101

注:1.以上壳体为通用件,安装尺寸均可相互参照 2."F.."表示F、FA、FF、FAF、FAZ

Note:1.The above housings are common parts.The mounting dimensions may consult each other. 2."F.."mean F、FA、FF、FAF、FAZ